



Wiring Of Profile

End exit, red wire is positive, black wire is negative.



Driver Wiring

Ensure all terminations are complete and secure.

Please use document

\*Optelma Wiring Instructions – REV O\*

Cut Out Notes

18mm x L\* + 1mm

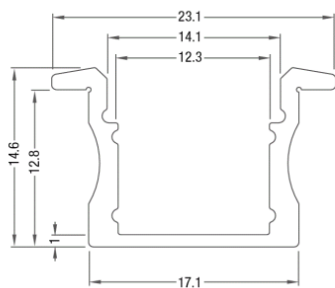

Fixing Method One

Use a bonding adhesive along the back of the profile, and glue into the slot.

Fixing Method Two

Metal mounting clips, screw into channel, and clip profile in place.

