

# QUAD 38

**ID: QU38**

**TYPE: Module / Made-to-Measure**

**MOUNTING: Surface**

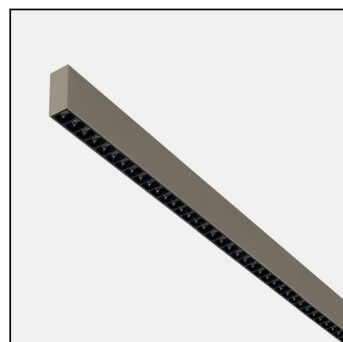
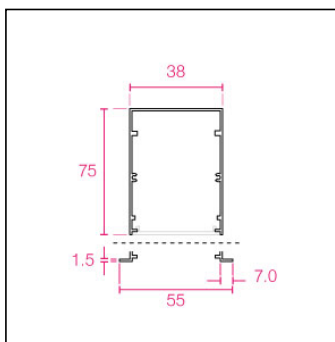

**1A.**

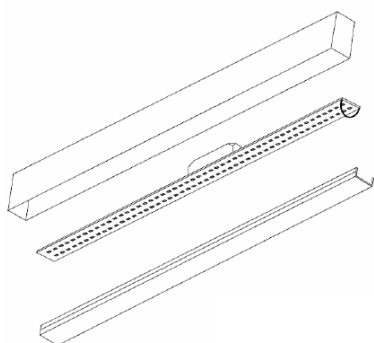

## Diffuser and gear tray removal

All gear trays are numbered, Made-To-Measure luminaires follow the technical drawing

**1B.**

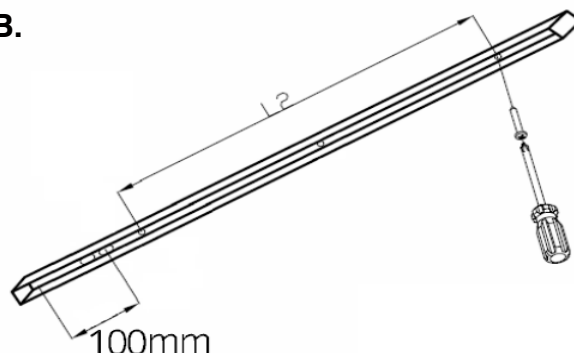

## Module fixing spacings

Use the table in 1C to choose your module length and provide the L2 dimension.

**1C**

| L1[mm] | L2[mm] |
|--------|--------|
| 600    | 200    |
| 890    | 490    |
| 1182   | 782    |
| 1475   | 1075   |
| 1765   | 1365   |
| 2350   | 1950   |
| 2930   | 2530   |

## Module fixing spacings continued

Measure distance on Made-To-Measure luminaires.  
Ensure all terminations are complete and secure.  
Please use document "Optelma\_INSTALLATION\_WIRING\_REV\_L"

**1D.**

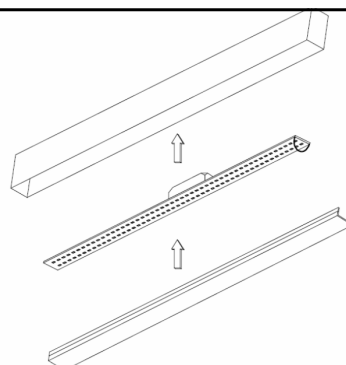

## Diffuser and gear tray reassembly



**60 YEARS  
IN LIGHT**

CALL: +44 (0) 1235 55 37 69  
EMAIL: sales@optelma.co.uk

**HEAD OFFICE**  
The Science Park  
Abingdon  
Oxfordshire OX14 3YT  
United Kingdom

**SHOWROOM**  
23 Bowling Green Lane  
Clerkenwell  
London EC1R 0BD  
United Kingdom

**PARIS OFFICE**  
28 Rue Charles  
Baudelaire  
75012 Paris  
France

**SWISS OFFICE**  
St. Urbangasse 53  
Postfach 1738  
CH-4502 Solothurn  
Switzerland