

MICROBLADE DOOBLE

ID: MBDO

TYPE: Made-to-Measure

MOUNTING: Recessed Plaster-in

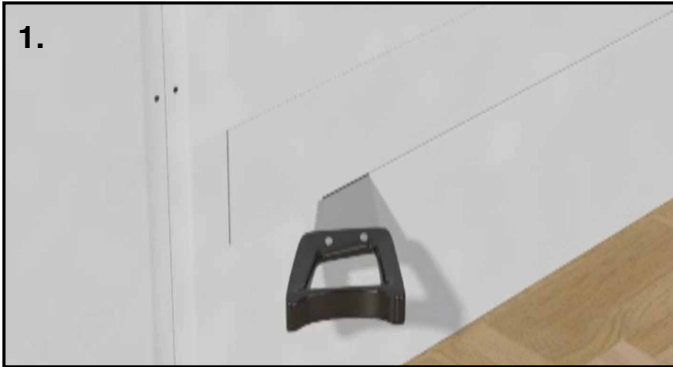
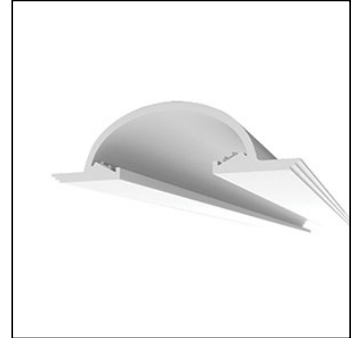
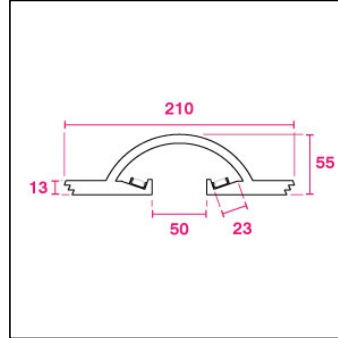

1. Cut Out Slot

Cut out a slot in the drywall to the width of the plaster profile (not including metal tabs). For lengths see project-specific drawings.



2. Cut Out Slot

Remove the cut-out panel and check all edges are straight and true. Where necessary, place 24V drivers and power leads behind the plasterboard, ready to poke through plaster profiles.



3. Glue End Caps

Apply plaster adhesive to the end caps.
(If you are not using end-caps with your solution, go to step 5)

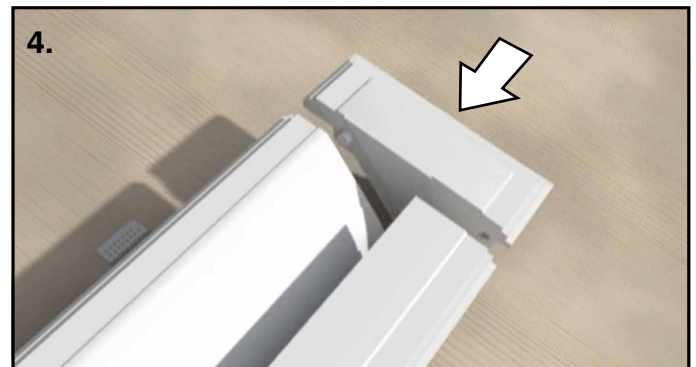

4. Attach End Caps

Attach the end-caps and let them set, strong and secure. Drill any holes for lead-wires in through the back of the profile, ensuring it will be somewhere accessible, but NOT visible post-installation.



**60 YEARS
IN LIGHT**

CALL: +44 (0) 1235 55 37 69
EMAIL: sales@optelma.co.uk

HEAD OFFICE
The Science Park
Abingdon
Oxfordshire OX14 3YT
United Kingdom

SHOWROOM
23 Bowling Green Lane
Clerkenwell
London EC1R 0BD
United Kingdom

PARIS OFFICE
28 Rue Charles
Baudelaire
75012 Paris
France

SWISS OFFICE
St. Urbangasse 53
Postfach 1738
CH-4502 Solothurn
Switzerland

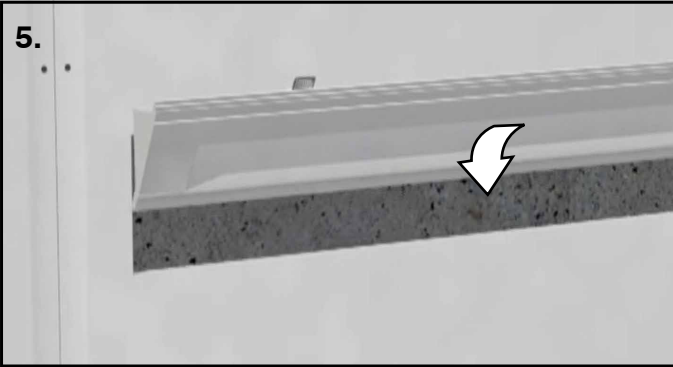

5.

Place Into Slot
Guide the profile length into the cut-out slot, tilting to push it through and bringing it back forward so that the metal tabs sit against the back of the plasterboard.

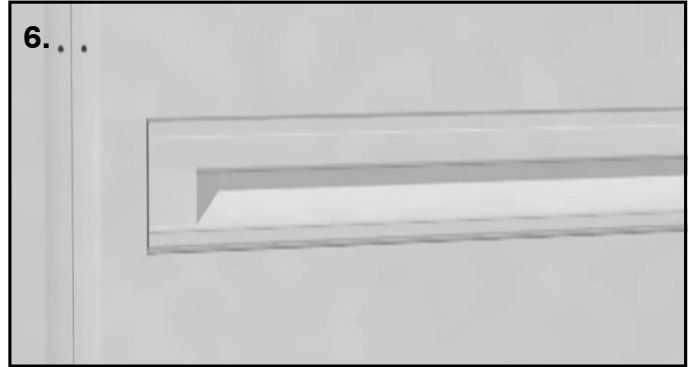

6. . .

Position Profile
Pull the profile forward so the front face is flush with the plasterboard surface, and the tabs are held against the back of the plasterboard.

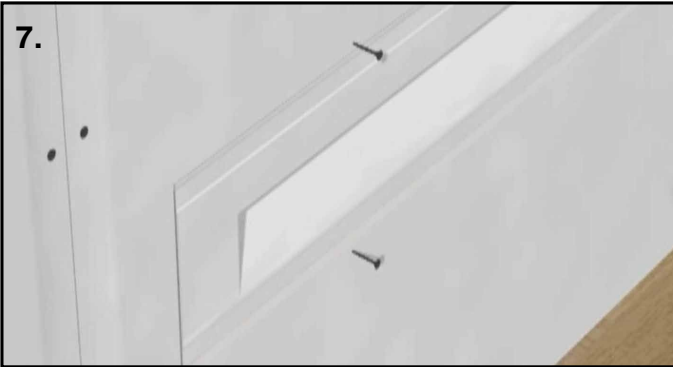

7.

Screw Through Plasterboard
Noting the position of the metal tabs, screw through the plasterboard.

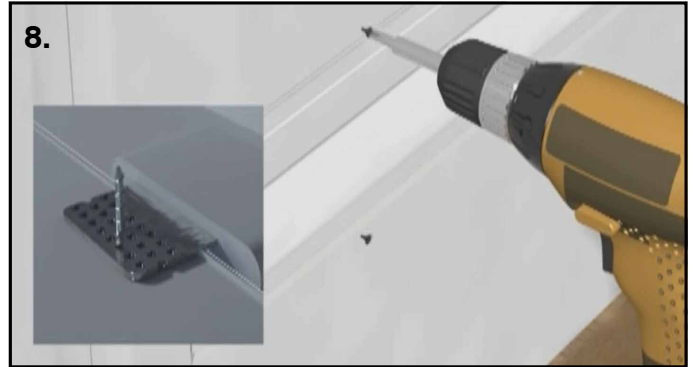

8.

Don't Overtighten
Ensure that the screws grip through the metal tabs and pull the profile flush, but do not overtighten! This will ruin the integrity of the plasterboard.

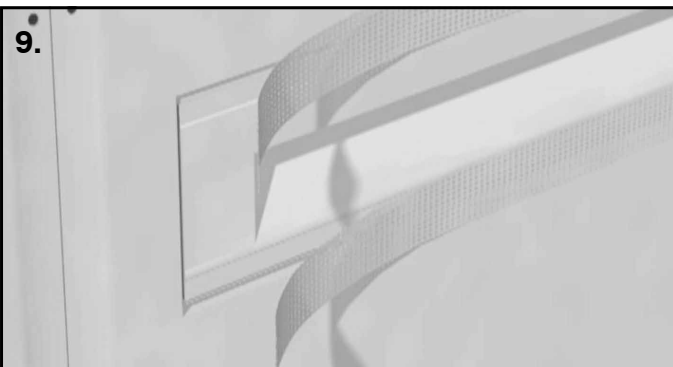

9.

Apply Mesh Tape
Apply mesh tape over the feathered joints. The wall/ceiling is now ready to be skimmed by a professional plasterer.

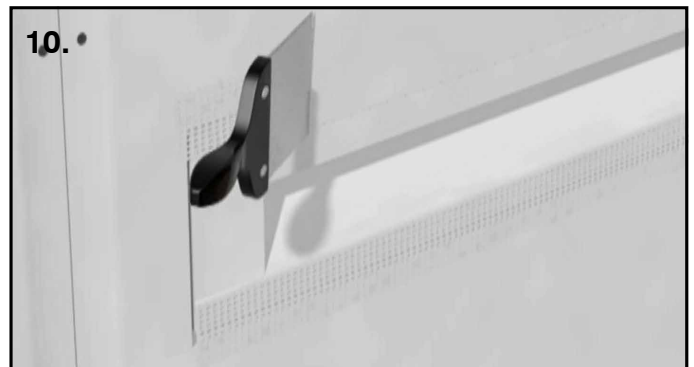

10. .

Skim Over Seam
Plaster over the gap/seam with a thin skim layer. Taper toward the open profile gap. The finished result should seamlessly integrate into the wall/ceiling with no visible joints.



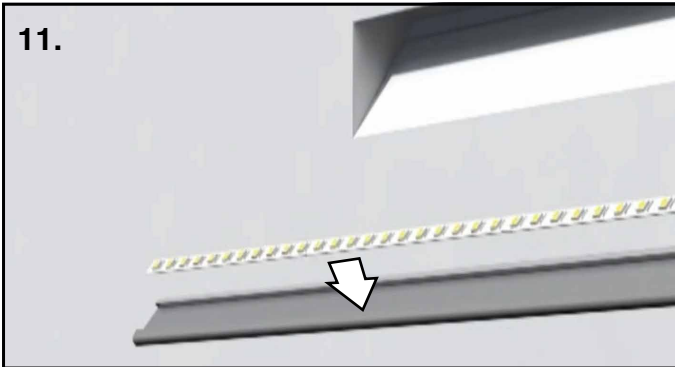

11. Adhere LED Tape
Your profile may already come with tape installed. If not, stick the tape along the centre of the heatsink channel. Cut to length using the designated cut-points, and solder low-voltage lead wires on.

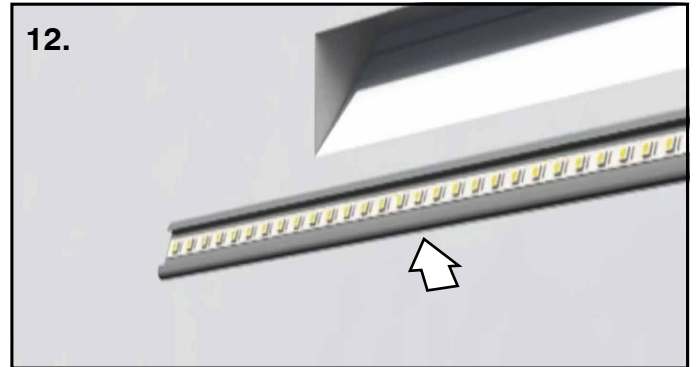

12. Glue Heatsink Profile
Apply a long bead of glue to the back of the heatsink profile.

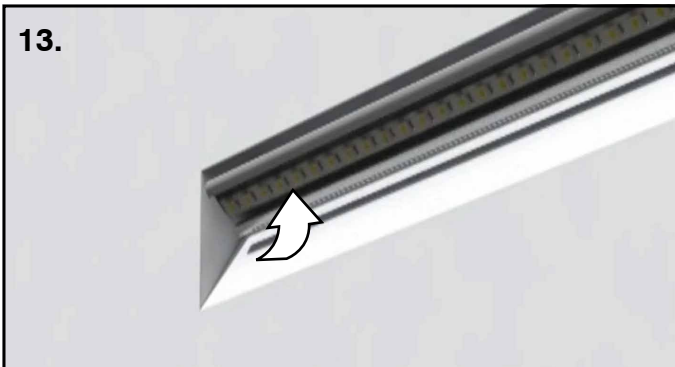

13. Attach Heatsink Inside Plaster
Stick the heatsink inside the plaster profile channel, attaching to power and pushing through any slack lead wires. See cross-section for correct positioning.

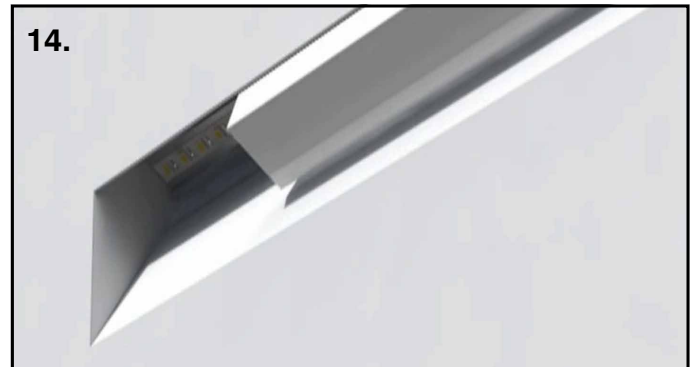

14. Insert Diffuser
If your plaster profile comes with a frosted Opal diffuser, slot it into the profile ensuring an even, level orientation.

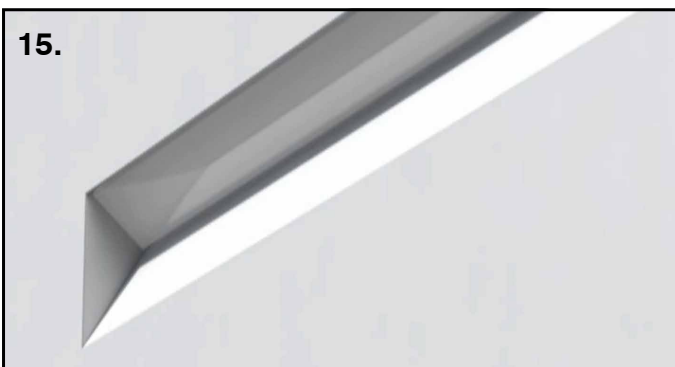

15. Paint Over Finished Profile
The profile is now ready to be painted to match the wall/ceiling around it. Remove the diffuser and protect the LED inside if you need to paint inside the plaster profile aperture.

